

Terminator™ ZP-MI-WP

Power Connection Kit

INSTALLATION PROCEDURES

For Use with MI Mineral Insulated Heating Cable Sets



The Heat Tracing Specialists®

Terminator™ ZP-MI-WP

INSTALLATION PROCEDURES

Kit Contents . . .



Item	Quantity	Description
1	1	Expediter Assembly Support Cap with O-Ring Threaded Grommet Compressor Grommet Wall Mount Support Base with O-Ring
2	1	Junction Box Lid
3	1	Junction Box Base with O-Ring
4	1	Wall Mount Bracket
5	3	M5 Screws
6	3	Lock Washers
7	1	Terminal Block with DIN Rail
8	1	Junction Box Lid Cord
9	1	Nut
10	1	Power Gland
11	1	Blind Plug
12	2	Wire Pins (per MI Cable Cold Lead)
13	1-2	Banding (Optional, see Steps 1a or 1c)
14	1	XP-1 Bracket (Optional, see Step 1c)

Wire Pins (per MI cable cold lead, order separately)



B-type Tanding (order separately)

B-4: for pipes up to 4"

B-10: for pipes up to 10"

B-21: for pipes up to 21"



XP-1-140X80 Stainless Steel Mounting Bracket (order separately)

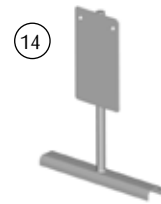

Tools Required . . .

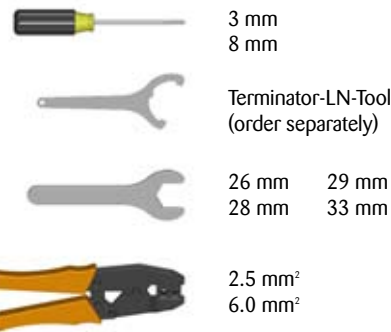

Certifications/Approvals . . .

IP66 -60°C ≤ Ta ≤ +55°C

Ordinary & Hazardous Locations

IECEx FMG 10.0022X Ex eb IIC T4-T6, Ex tb IIIC T135°C-T85°C

CE 1725 Ex II 2 GD Ex eb IIC T4-T6, Ex tb IIIC T135°C-T85°C FM 10ATEX0058X

Warnings . . .

- Due to the risk of electrical shock, arcing and fire caused by product damage or improper usage, installation or maintenance, a ground-fault protection device is required.
- Installation must comply with Thermon requirements and be installed in accordance with the regulations as per the norm EN IEC 60079-14 for hazardous areas (where applicable), or any other applicable national and local codes.
- Install correct heating cable lengths indicated in the design. Any deviations from these lengths will result in a change in outputs.
- Component approvals and performance ratings are based on the use of Thermon specified parts only.
- De-energize all power sources before opening enclosure.
- Keep ends of heating cable and kit components dry before and during installation.
- Minimum bending radius of heating cable is 6 times the cable outer diameter.

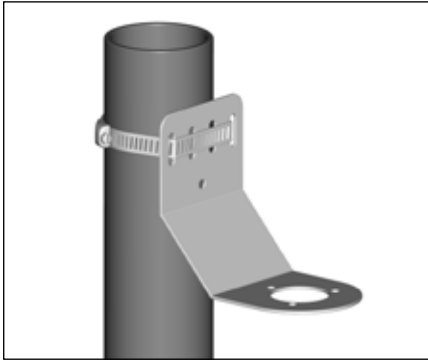

1a. Mounting Method 1: Secure wall mount bracket to mounting surface using pipe band.

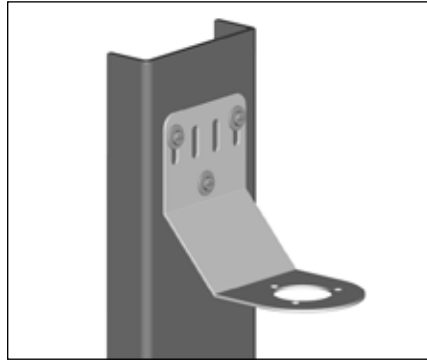

1b. Mounting Method 2: Secure wall mount bracket to mounting surface using screws, washers, and nuts (user supplied)

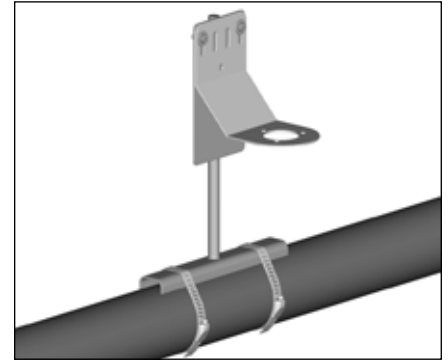

1c. Mounting Method 3: Secure XP-1 mounting bracket to pipe using pipe bands. Secure wall mount bracket to XP-1 using screws, washers, and nuts (user supplied)

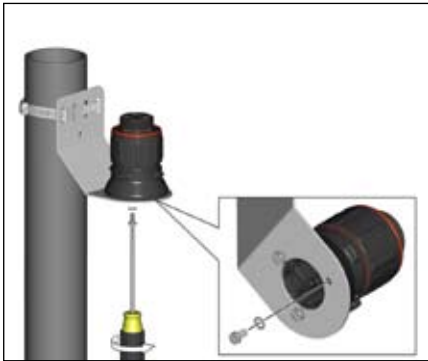

2. Mount expediter to bracket using M5 screws and lock washers.

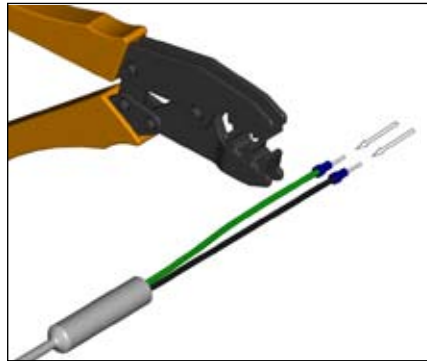

3. Crimp appropriate wire pins (2.5 mm² or 6 mm²) on MI cable cold lead wires.

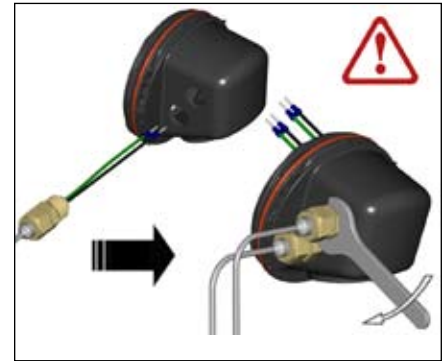

4. Route MI cable cold leads through M20 threaded entries. Screw cable glands into junction box. Do not overtighten to ensure o-ring is not damaged during installation.

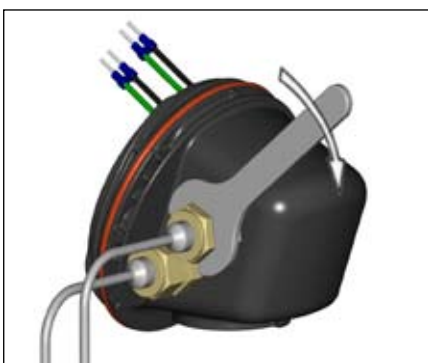

5. Center cold lead sleeve inside cable gland. Tighten cable glands until ferrule begins to make contact with cold lead sleeve and cold lead sleeve cannot be moved by hand. Tighten cable gland 1/8 additional turn or to a torque value of 16 Nm (142 lb-in).

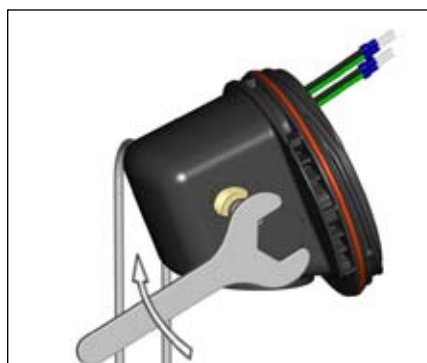

6. Install M20 blind plug in remaining M20 threaded entry (if necessary). Additional M20 blind plug (order M20-B-EXE) will be required if only installing one gland.

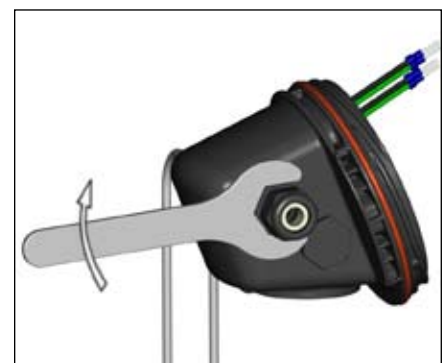

7. Install M25 power gland in M25 threaded entry. For in-line splice or 3 phase wye connection, install M25 blind plug (order M25-B-EXE separately) instead of M25 power gland.



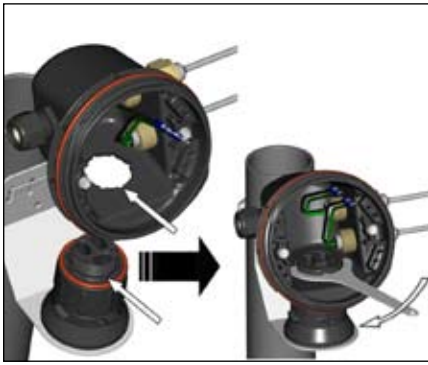

8. Mount junction box base on expediter. Make sure to align slots to properly orient junction box base. Tighten nut with Terminator-LN-Tool. If mounting horizontally, threaded gland holes must face downward.

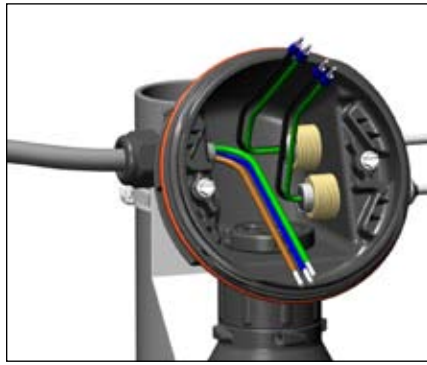

9. Install power cable (if necessary).

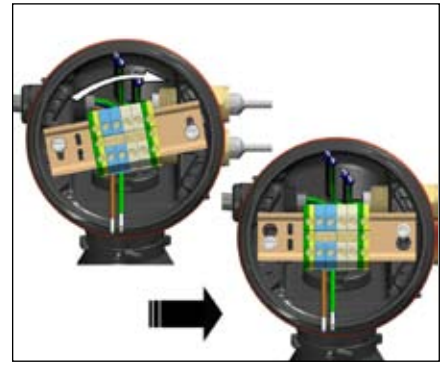

10. Install quick mount terminal blocks and tighten screws (if necessary).

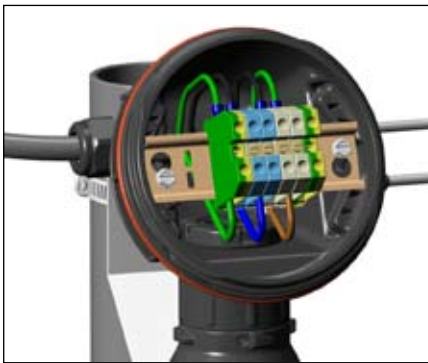

11. Complete system wiring. Terminal set screws shall be tightened to a torque value of 1.4 Nm (12.4 lb-in). See page 5 for wiring details.

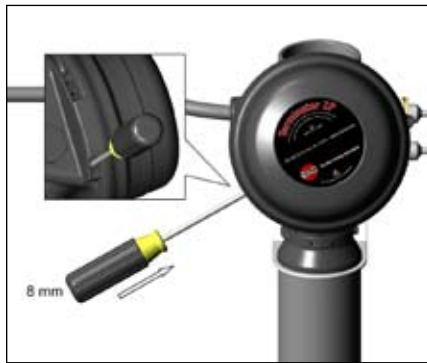

12. Install junction box lid and twist hand tight. Insert screwdriver into ratchet slots located on side of junction box base



13. Use screwdriver to ratchet on junction box lid. Lid will rotate 30 degrees.

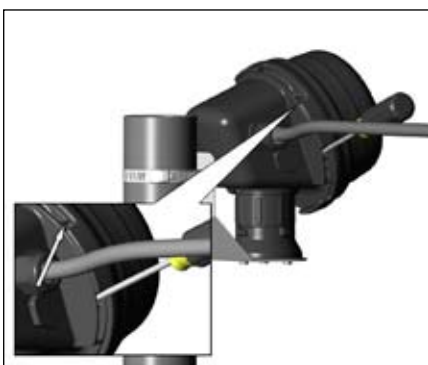

14. Lid latch mechanism fully engaged. To remove lid, repeat steps 12 and 13 but in the opposite direction.

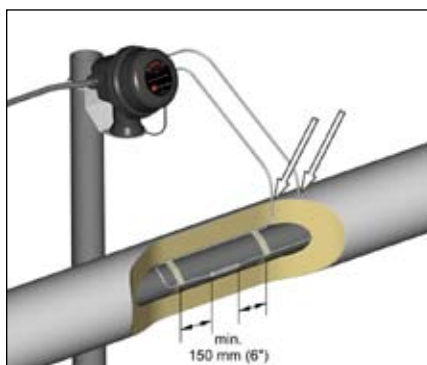

15. Seal temperature sensor penetration through insulation cladding.

Wiring Details

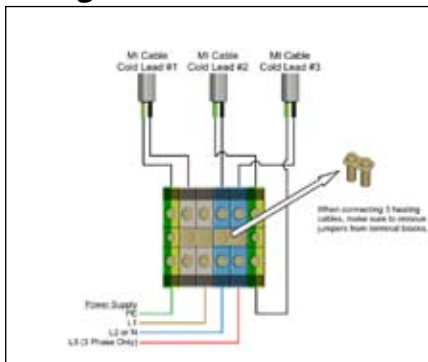

A1. Power Connection (1 to 3 MI Cable Cold Leads) When connecting three MI cable cold leads, make sure to remove jumpers from terminal blocks. When connecting only one MI cable cold lead, contact Thermon for design assistance.

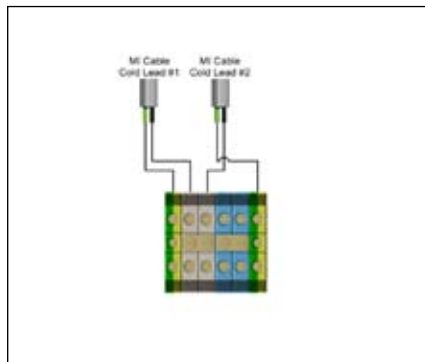

A2. In-Line Splice

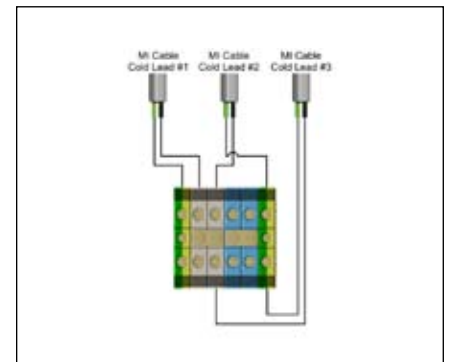

A3. 3 Phase Wye Connection





THERMON . . . The Heat Tracing Specialists®
www.thermon.com

European Headquarters
Boezemweg 25 • PO Box 205
2640 AE Pijnacker • The Netherlands
Phone: +31 (0) 15-36 15 370

Corporate Headquarters
100 Thermon Dr. • PO Box 609
San Marcos, TX 78667-0609 • USA
Phone: +1 512-396-5801

For the Thermon office nearest you
visit us at . . .
www.thermon.com

ISO 9001
REGISTERED

Specifications and information are subject to change without notice. Form PN50834U-1110